

# ESNA Strat Skua 26 - SES wind farm CTV

ESNA and Strategic Marine launch the next ESNA 26 m SES wind farm CTV (Strat Skua 26) with extremely low fuel consumption, high transit speed and outstanding seakeeping and boat landing performances. The design can be adapted to different client cargo, passenger or machinery configurations.

Main characteristics:	
Length over all	26 m
Beam moulded	11 m
Deadweight capacity	20 t
Passenger seats	24
Crew	2-4, (2+2 crew bunks)
Bollard push	10 t
Boatlanding capacity	2 m Hs in all directions
Propulsors	2 x waterjets
Fore cargo deck	30 m <sup>2</sup> (5 tonnes)
Max. Cargo deck load (Specified area)	1.0 t/m <sup>2</sup> (Optional up to 2 t/m <sup>2</sup> )
Crane	Optional Palfinger PC2700M
Performance (26 m with 2x 1491kW on main shafts)	
Max speed at SS0, 10 t DW	48 knots
Service speed in 1 m Hs at 80% MCR, 10 t DW	33 knots
Fuel consumption	15 litres/nautical mile

IMO Tier III compliant drive system alternatives:	
Mechanical (6 DE)	- 2 x (>1400 kW) for WJ, Caterpillar C32B @ 1491kW or MTU V16 S2000 - 2 x FPT N60 400 for lift fans - 1 x AC Genset for Hotel ( Opt. 2x)
Diesel-electric drive of SES and hotel Systems (4 DE)	- 2 x (>1400 kW) for WJ, Caterpillar C32B @ 1491kW or MTU V16 S2000 - 2 x VOLVO PM Gensets D8 MH 250 kWe with Danfoss electric PM generator for DC distribution
Fully hybrid (2 DE)	2 x (>1400 kW) for WJ, Caterpillar C32B @ 1491kW or MTU V16 S2000 with PM shaft generator/ DC power distribution to SES and hotel
Quad Option (4 DE)	- 4 x MAN D2862 @ 882kW with PM shaft generator/DC power distribution to SES and hotel - Moulded beam increases to 12.2m

**Contact**  
 Stig Gjelsten, +47 93 07 72 61, stig.gjelsten@esna.no or  
 James Lewis, +44 79 73 11 62 75, james.lewis@strategicmarine.com  
[www.esna.no](http://www.esna.no) / [www.strategicmarine.com](http://www.strategicmarine.com)



# Strat Skua 26 - SES wind farm CTV

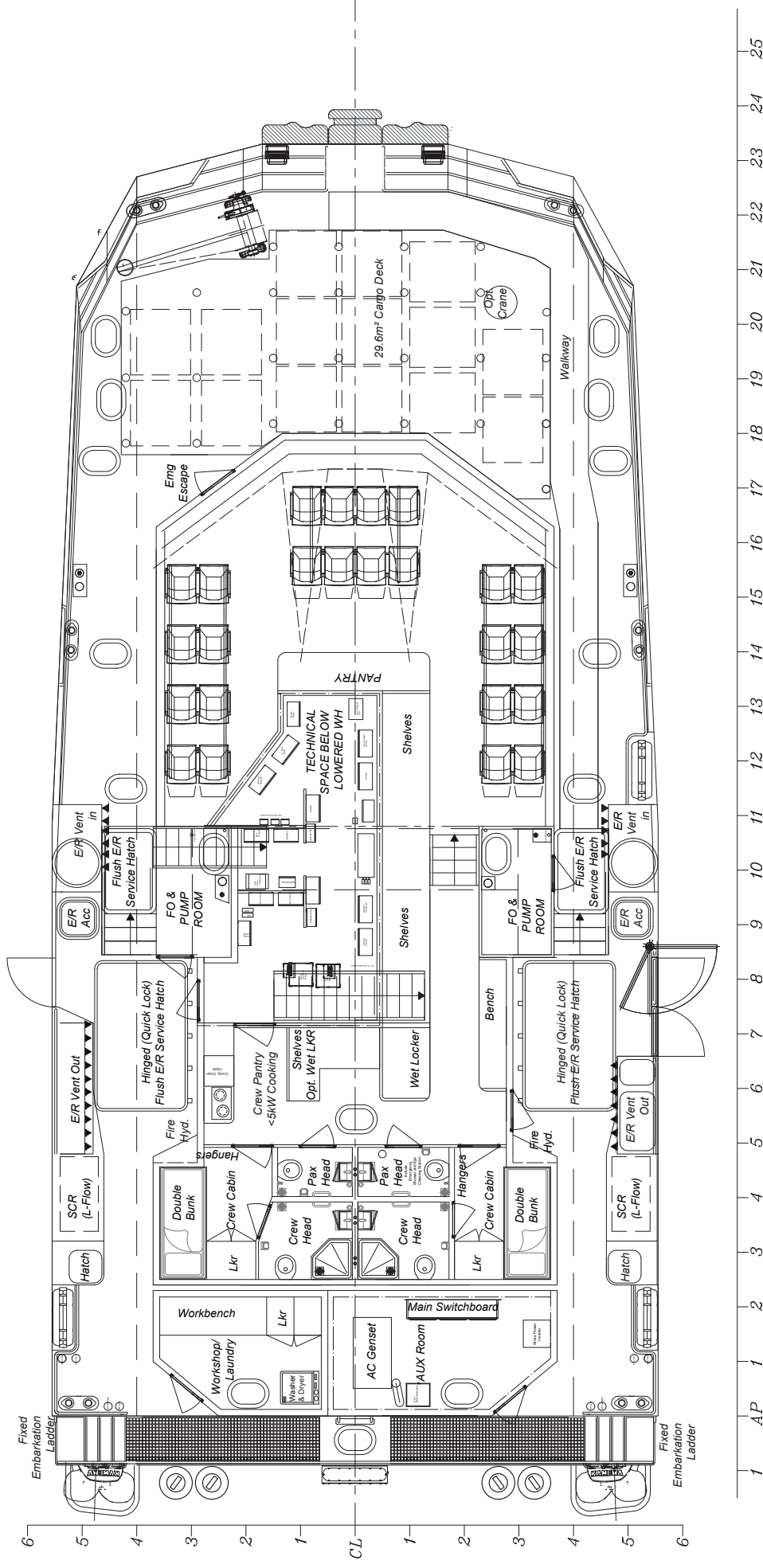

MAIN DECK

Contact  
 Stig Gjelsten, +47 93 07 72 61, stig.gjelsten@esna.no or  
 James Lewis, +44 79 73 11 62 75, james.lewis@strategicmarine.com  
 www.esna.no / www.strategicmarine.com

